

1/4" HIGH ACOUSTIC THRESHOLD 5" WIDTH TO BE INSTALLED ON FINISHED FLOOR

ELEVATION

NOTE : FRAME MUST BE INSTALLED AT FINISHED FLOOR HEIGHT (DO NOT EMBED IN FLOOR)

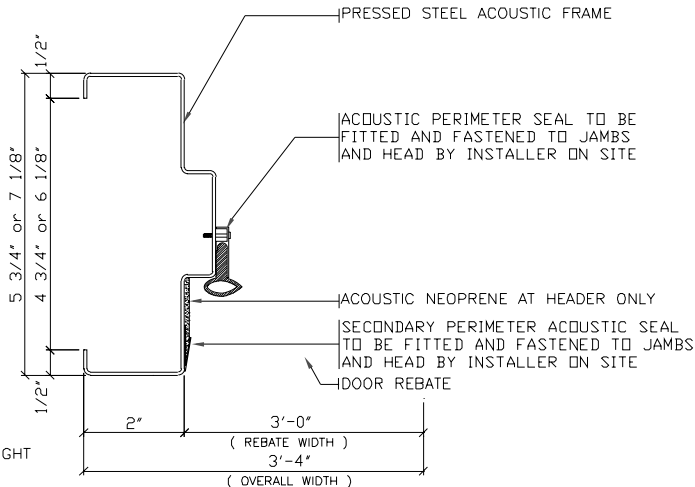

TYPICAL JAMB SECTION

THIS DRAWING IS A TYPICAL ACOUSTIC STEEL FRAME AND SEAL RENDERING. FOR FURTHER IN-DEPTH DRAWING OR TECHNICAL DATA, CONTACT OUR SALES OR ENGINEERING DEPARTMENTS.