

NOTE: THESE DRAWINGS ARE ISSUED FOR GENERAL INFORMATION ONLY AND ARE NOT INTENDED FOR MODIFICATION. FOR FURTHER INFORMATION PLEASE CONSULT OUR SALES OR ENGINEERING DEPARTMENTS.

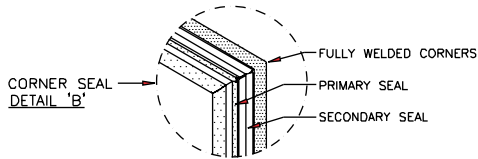

PRESSED STEEL ACOUSTIC FRAME

ACOUSTIC ABSORPTION CHAMBER

ACOUSTIC PERIMETER SEALS TO BE FITTED AND FASTENED TO JAMI

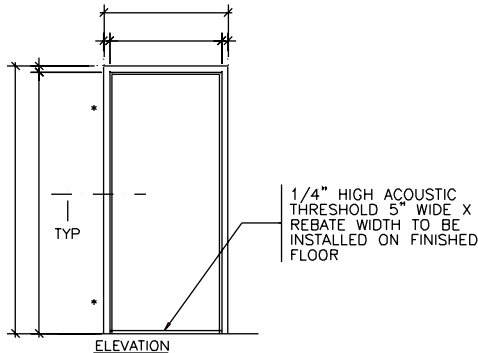

NOTES:

- * FRAME TO BE PREPARED FOR __ PR CAM-LIFT HINGES.
- ** ACOUSTIC SEALS DIMINISH THE FRAME CLEAR OPENING SIZE AS FOLLOWS:
 - REBATE WIDTH LESS 2 1/2" (63.5mm) = CLEAR OPENING WIDTH
 - REBATE HEIGHT LESS 1 1/4" (31.75mm) = CLEAR OPENING HEIGHT.
 - FRAME MUST BE INSTALLED AT FINISHED FLOOR HEIGHT (DO NOT EMBED JAMB IN FLOOR)

TYPICAL JAMB SECTION